

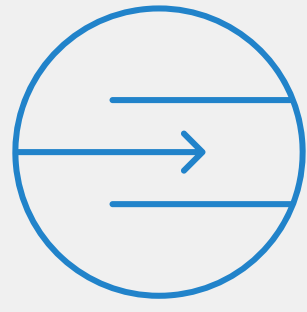

Excellent kink  
and deformation  
resistance

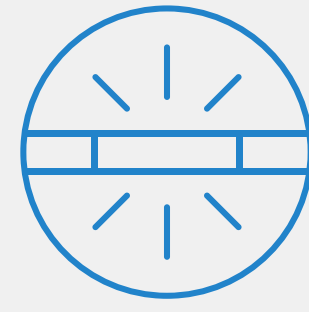

Easy insertion



Superb radiopacity



Technical data /  
ordering info

Vascular Intervention // **Peripheral**  
Reinforced Introducer Sheath System

 **BIOTRONIK**  
excellence for life

# Fortress<sup>®</sup>

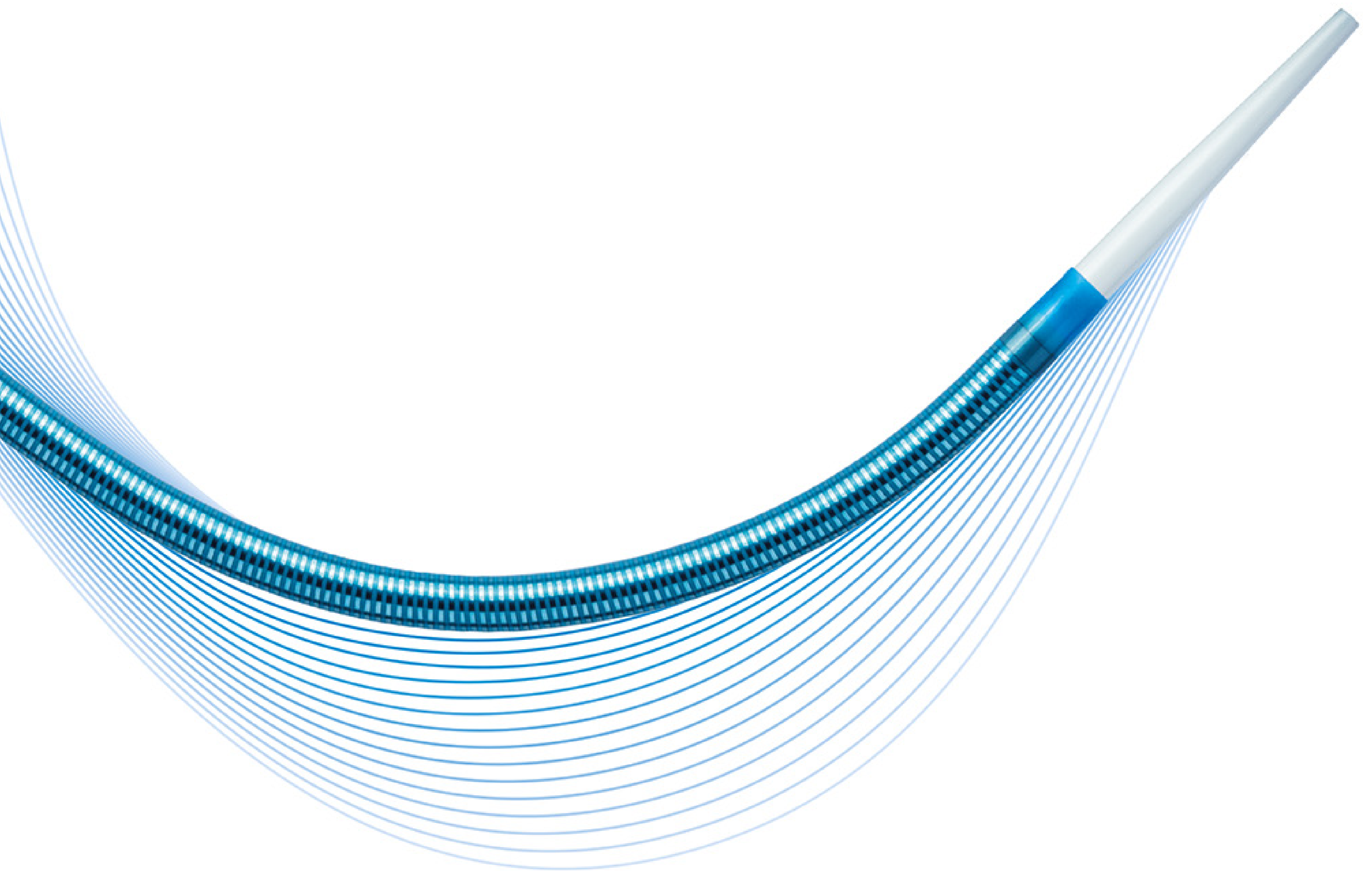

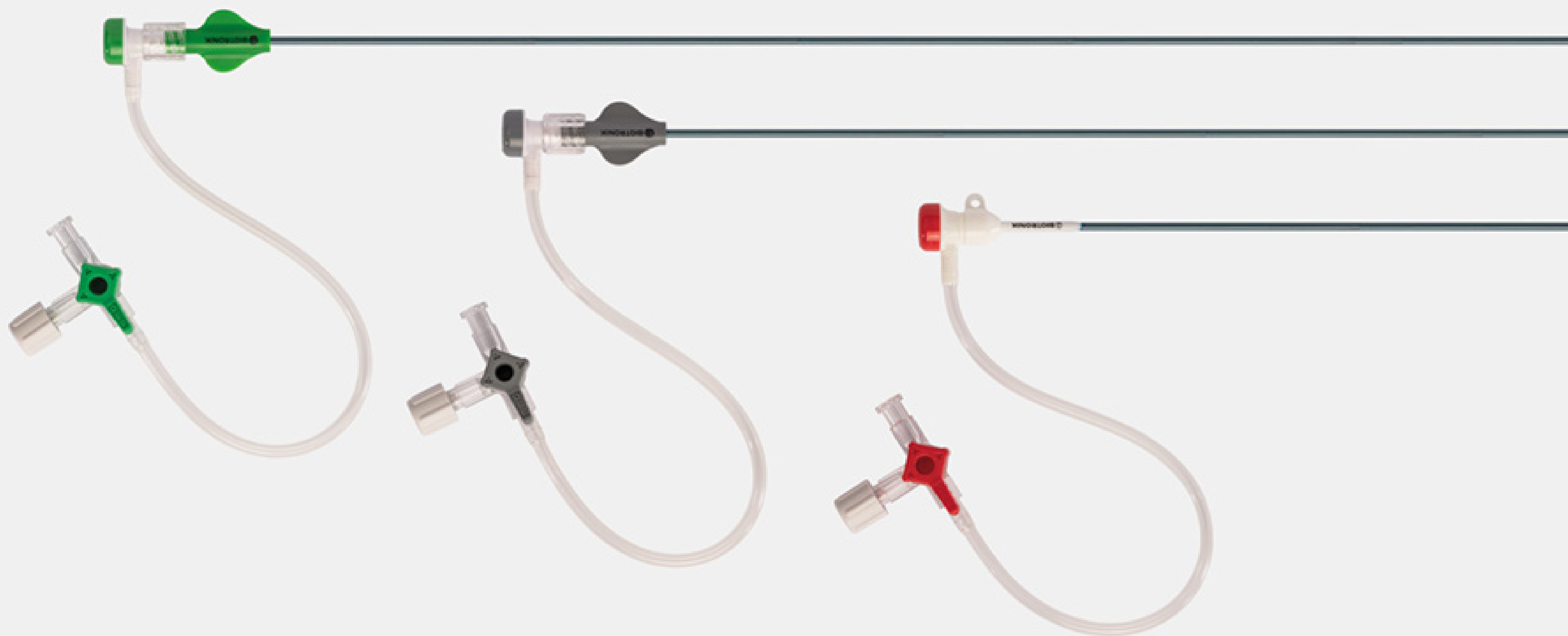

## Excellent kink and deformation resistance

### Coil reinforced sheath

The polymer embedded stainless steel coil shaft provides flexibility and excellent kink and deformation resistance.

### PTFE liner

The non-ovaling characteristic combined with its friction lowering PTFE liner enables devices to easily pass through tight anatomical curves.

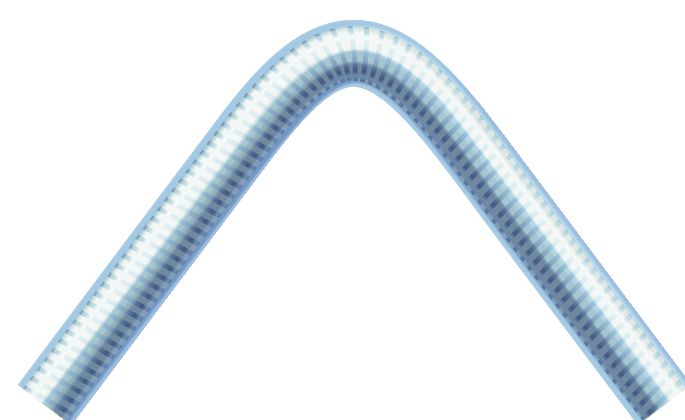
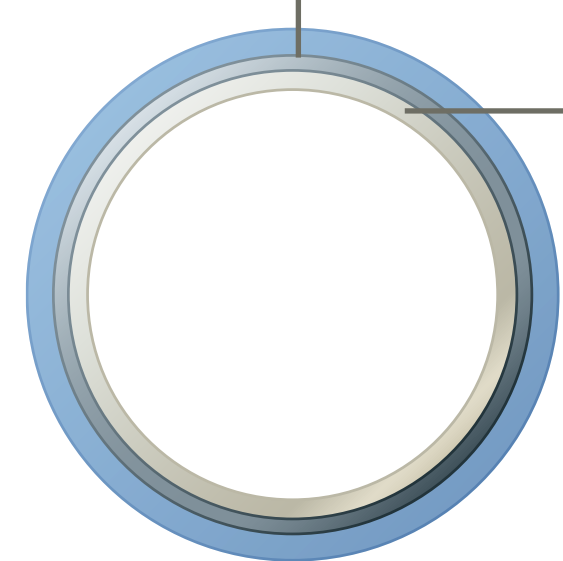
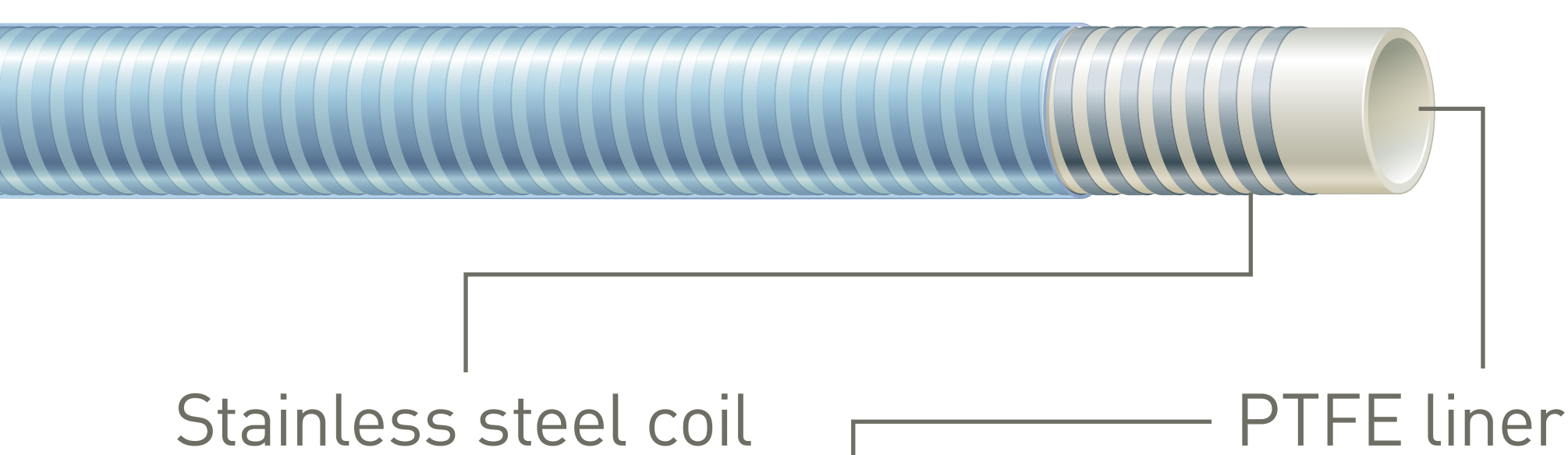

**Fortress's** coil reinforced sheath does not oval when curved, maintaining lumen diameter.

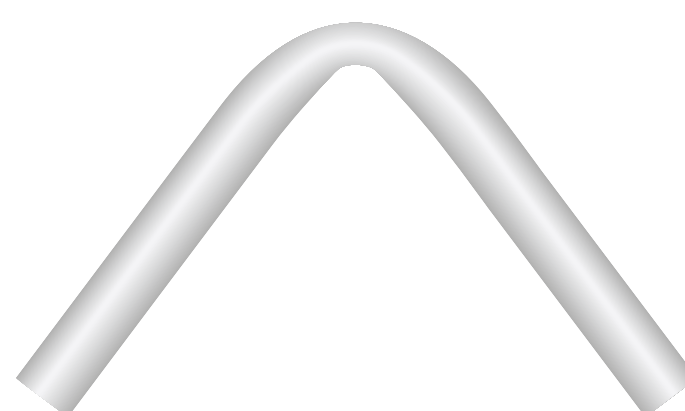
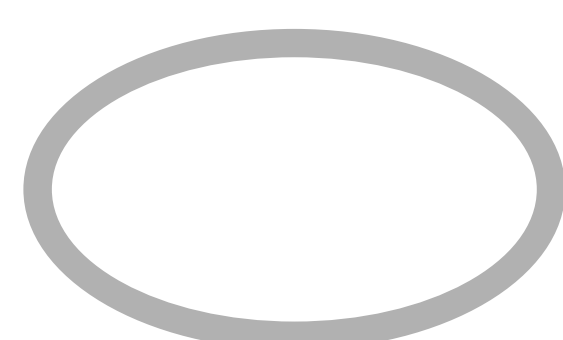

**Standard competitor** non-reinforced sheath ovals when curved, thereby reducing the lumen diameter.

Cross section curved sheath

Curved sheath







## Easy insertion

### Smooth tapered sheath and dilator tip

The sheath and dilator have a smooth tapered tip and an atraumatic tip design for ease of insertion.

### Hydrophobic coated sheath<sup>1</sup>

Best in class insertion performance<sup>2</sup> due to the hydrophobic sheath coating in combination with the smooth tapered sheath and dilator tip.

## Superb radiopacity

### Radiopaque sheath marker

The platinum alloy marker band provides superb tip radiopacity under fluoroscopic imaging.<sup>3</sup>

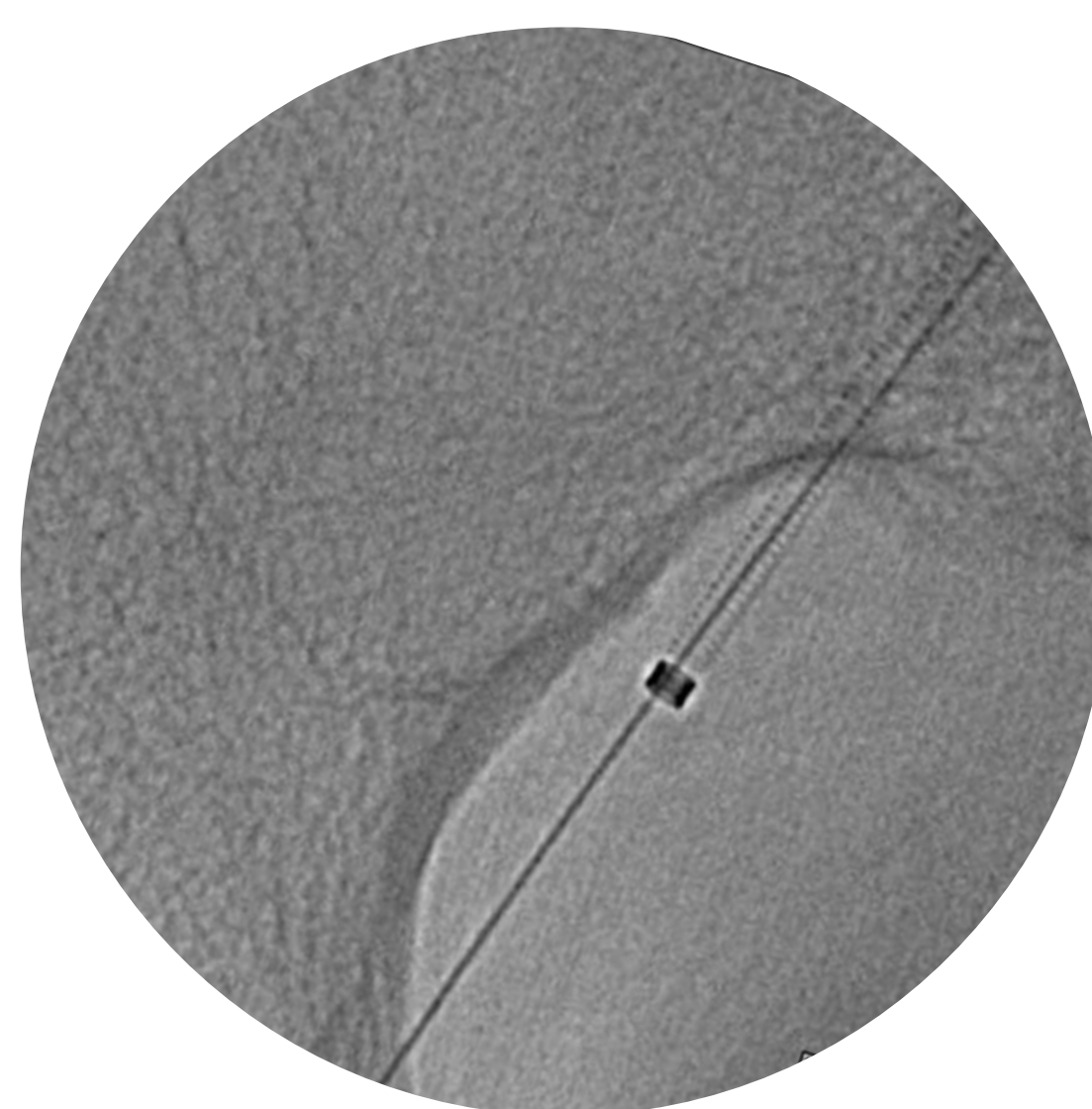

Fortress 4F in the pelvic area

### Minimal is optimal

4F

The BIOTRONIK 4F Solutions product portfolio allows for treatment of complex lower limb disease while reducing access site complications.





# Fortress

Indicated to provide access into the femoral, popliteal and infrapopliteal arteries.\*

Vascular  
Intervention  
Peripheral

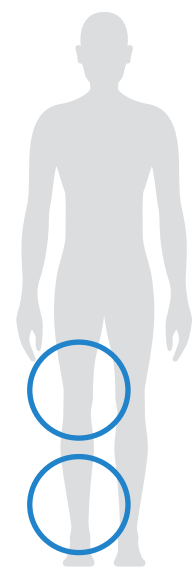

Technical Data		Introducer Sheath	
		French size	4F, 5F and 6F
		Length	45, 65 and 90 cm
		Sheath material	Stainless steel coil reinforced polymer, PTFE liner
		Sheath tip	Smooth taper with radiopaque marker band located 3-5 mm from the sheath tip
		Sheath shape	Pre-curved 45 cm Straight 45, 65 and 90 cm
		Sheath coating	Hydrophobic, distal 30 cm (5F and 6F only)
		Dilator	
		Recommended guide wire	0.035"
		Tip	Smooth taper with radiopaque filler material
		Shape	Pre-curved and straight
		Hub	4F: fixed hemostatic valve 5F, 6F: removable hemostatic valve Side-arm with color coded 3-way stop cock

Ordering Information		Sheath length (cm)	Sheath shape	Introducer description	Catalogue number	Dilator(s) included	Units per box
4F		45	Curved	Crossover	358813	Curved / Straight	5
		45	Straight	Straight-45	358814	Curved / Straight	5
		65	Straight	Straight-65	444486	Straight	5
		90	Straight	Straight-90	444485	Straight	5
5F		45	Curved	Crossover	386590	Straight	5
		45	Straight	Straight-45	386591	Straight	5
		65	Straight	Straight-65	444484	Straight	5
		90	Straight	Straight-90	444483	Straight	5
6F		45	Curved	Crossover	386593	Straight	5
		45	Straight	Straight-45	386594	Straight	5
		65	Straight	Straight-65	444482	Straight	5
		90	Straight	Straight-90	444481	Straight	5

1. 5F and 6F sheath; 2, 3. BIOTRONIK data on file.  
\*Indication as per IFU.  
Fortress is a trademark or registered trademark of the BIOTRONIK Group of Companies.

**Manufacturer:**  
Contract Medical  
International GmbH  
Lauensteiner Strasse 37  
01277 Dresden, Germany  
Tel +49 351 213 88 88  
Fax +49351 21388 99  
info@contract-medical.com  
www.contract-medical.com

**Distributor:**  
BIOTRONIK AG  
Ackerstrasse 6  
8180 Bülach, Switzerland  
Tel +41 (0) 44 8645111  
Fax +41 (0) 44 8645005  
info.vi@biotronik.com  
www.biotronik.com

