

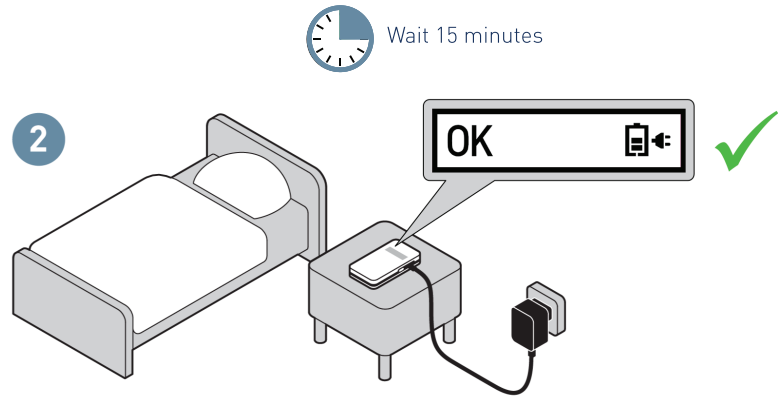

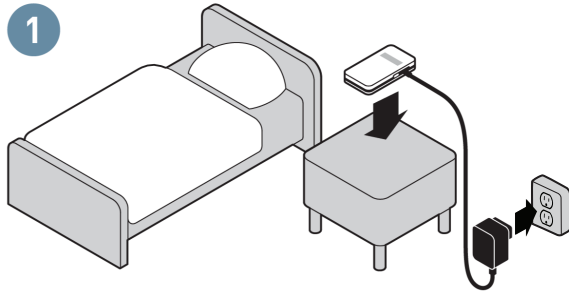



CardioMessenger® Smart

Quick Start Guide



CardioMessenger® Smart

LCD Icons

	Operation icon. The CardioMessenger is ready for us.
	Call back icon. If this icon flashes, contact your physician during normal office hours. Refer to Section 4 of the CardioMessenger Smart Technical Manual for more information.
	Information icon. If this icon flashes, a cellular connection cannot be established. Please try relocating the device in the room. Refer to Section 5 of the CardioMessenger Smart Technical Manual for more information.
	The battery icon is always displayed with 1-3 bars according to the charging status. Refer to Section 6 of the CardioMessenger Smart Technical Manual for more information.
	The CardioMessenger is connected to the power supply and charging.